

# Thomsen's Maestro

## Dual Escalator Handrail Cleaning System



## TH-E-0007 Thomsen's Maestro Dual Escalator Handrail Cleaning System



- **Universal Cart System & Dolly System**
- **4 Foam Pad Holders**
- **24 Cleaning Pads**
- **Three 1.5gal Charging Buckets**
- **One ½ gallon mixing pitcher**
- **Three 1 oz. gallon pump dispensers**
- **One Bottle holder**

The system is a non-motorized, safe, and simple system to remove dirt, grime, and bacteria from moving handrails.

Specially designed microfiber cleaning pads attached to molded pad holders clean the moving handrails from “bead to bead.”

The Dolly System attaches to non-obstructed moving handrails and cleans without interrupting the operations, minimizing the impact on foot traffic.

Handrail Cart System's patented swivel arm easily placed for access to any handrail.

Universal and Dolly System nested for compact, convenient transport and storage.

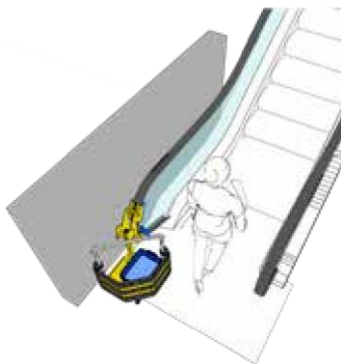

**The unique swivel mount allows the cart to clean handrails directly next to walls or other obstacles**

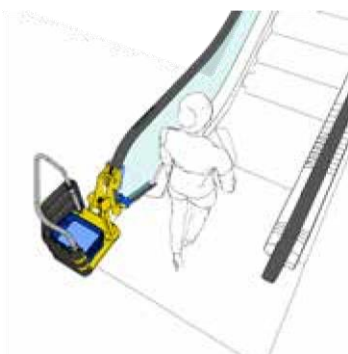

## TH-E-0001 Universal Handrail Replacment Cart



Includes:



- 2 Foam Pad Holders
- 1 – 12 Packs Cleaning Pads

## TH-E-0013 Dolly Replacement Cart



Includes:



- 2 Foam Pad Holders
- 1 – 12 Packs Cleaning Pads

Dual System saves time and  
labor by cleaning both  
handrails simultaneously.



## TH-E-0033

Foam Pad Holder  
Replacement



## TH-E-0041

Cleaning Pad 12 - Pack



- **Proprietary microfiber handrail cleaning pads for use on all Thomsen's Foam Pad Holders**
- **Our cleaning pads have been proven to remove 99.94% of bacteria without cross contamination**
- **Wash and Reuse**

## TH-E-0046

SVC Charging Tray – 1 each



**Conveniently** hold Thomsen's mixed cleaning solutions

**Charge/soak** cleaning pads prior to cleaning handrails

**Trays fit** on both Universal Cart and Dolly Systems

**Anti-skid pads** keep containers securely in place

**SVC Lids & Containers** are labeled for workplace safety compliance

## TH-E-0138 Thomsen's Baton Handheld Stationary Handrail Cleaning Tool



### Baton Handheld Tool Kit Includes:

- Ergonomic Handle** - with the ability to add an extension pole for access to footrails.
- Foam Pad Holder** - that easily adapts and self-molds to handrails of all sizes.
- 4 Dual-Sided Cleaning Pads** - are washable, reusable, and delicate to the surfaces being cleaned. Removes 99.94% of bacteria.



**Flexible** handle connection allows for easy maneuvering to ensure the best cleaning results. Small, compact, and fits easily on any janitorial cart.

**Utilizes** the same supplies and technology as our other market-leading products for easy, efficient cleaning of stationary handrails.

**Clean Handrails**, guardrails, guide rails, banisters. i.e., ADA handrails, stairways, walkways, and more.

**Safe & Effective** on Metal, Rubber, Fiberglass, Wood, Linoleum, and Plastic

**Use with All Thomsen's** Cleaning, Conditioning, and Sanitizer solutions or with rail-specific manufacture recommended solutions i.e., brass cleaner for brass rails, hospital rail required cleaners and more.





## **TH-C-0075** Thomsen's Heavy Duty Cleaner Concentrate 4 x 1 Gallon Case

**Proprietary and specially formulated by Thomsen's to deep clean rubber escalator handrails that are badly soiled or have not had regular cleaning.**

- **Non-Caustic & Non-Corrosive**
- **Portion Controlled**
- **Designed and tested specifically for repeated escalator handrail applications**



## **TH-C-0074** Thomsen's Cleaner Conditioner Concentrate 4 x 1 Gallon Case

**Proprietary and specifically formulated by Thomsen's for ongoing maintenance of escalator and stationary handrails. Cleans, conditions, and maintains elasticity of rubber, vinyl, and plastic surfaces**

- **Will extend the life of the handrail 3 to 5 years**
- **Non-Caustic & Non-Corrosive**
- **Portion Controlled**
- **Designed and tested specifically for repeated escalator handrail applications**





## TH-S-0092 mPerial Escalator Handrail Sanitizer for Thomsen's 1 Gallon per case

Formulated for Thomsen's to routinely clean and sanitize  
escalator handrails.

- **Non-Caustic & Non-Corrosive**
- **Portion Controlled**
- **Designed and tested specifically for repeated  
escalator handrail applications**

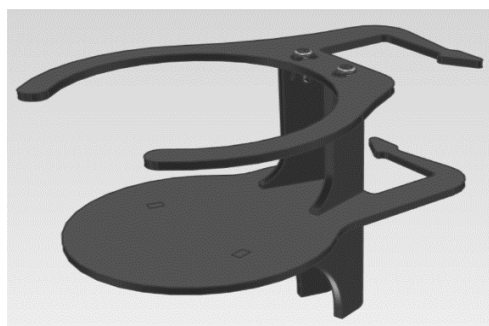

## Thomsen's 1/2 Gallon Bottle Holder TH-E-0087

Designed for placement on both the  
Universal and Dolly Cart to easily transport a  
1/2 Gallon Bottle of additional cleaning or  
sanitizer solution



## 1 oz. 1 Gallon Pump Dispenser for Thomsen's Solutions

TH-E-0093 Blue

TH-E-0094 Green

TH-E-0095 Red



Hygiena Partnership to Deliver **The Thomsen Way!**<sup>TM</sup>



## TH-E-0090 EnSURE<sup>TM</sup> Touch

ATP Metering Tool with documenting software to validate your cleaning and sanitation protocol. Realtime results of the before and after cleaning procedures

## TH-E-0091 Test Swabs

Replacement test swabs are packaged 4 packs of 25 Swabs, Swabs may require refrigeration if inventoried longer than 30 days

### UltraSnap<sup>®</sup> | Surface ATP Test

UltraSnap<sup>™</sup> is a user-friendly ATP surface test designed for use with Hygiena<sup>™</sup> luminometers. This all-in-one test contains a pre-moistened swab bud for optimal sample recovery. A unique liquid-stable reagent provides superior reproducibility and robustness. Hygiena's patented Snap-Valve<sup>™</sup> technology facilitates easy activation.

**Benefits:**

- Pre-wetted swab maximizes sample recovery and breaks through biofilm
- Unique liquid-stable reagent gives superior sensitivity and reliable results
- 100% recyclable plastic
- 15-month shelf life at refrigerated temperature (2 - 8 °C)
- 4-week shelf life at room temperature (21 - 25 °C)

**Sensitivity:**

Hygiena System	UltraSnap <sup>™</sup> Detection Limit
femtomoles ATP	10 fmol
ATP (fmol)	1 fmol
SystemSURE Plus	1x10 <sup>-14</sup>
EnSURE	1x10 <sup>-15</sup>
EnSURE Touch	1x10 <sup>-16</sup>

**Performance:**

UltraSnap's superior performance was validated in a third-party study conducted by a large reference laboratory. Hygiena's system demonstrated superior repeatability, and outstanding performance for linearity, sensitivity, and accuracy over other ATP systems.

Learn more at [www.hygiena.com](http://www.hygiena.com) or contact Hygiena for a full copy of the study.

Catalog No.	Description	Quantity
US2020	UltraSnap <sup>™</sup> Surface ATP Test	100

Find support documents, instructional videos, and more at [www.hygiena.com](http://www.hygiena.com)

**UltraSnap Procedure**

See an instructional demo at [HygienaTV](#) or [HygienaTV](#)

**Related Products**

### EnSURE Touch

**EnSURE<sup>™</sup> Touch Monitoring System**

EnSURE Touch is the next-generation quality monitoring system. It provides rapid and accurate sanitation verification to support your food safety program. EnSURE Touch features a 5" touch screen, wireless sync technology, and cloud-based software. EnSURE Touch is designed to adapt to your workplaces, providing the data you need for complex, multi-location supply chain monitoring, audit and risk management, and recall prevention.

**AquaSnap<sup>™</sup> Water ATP Tests**

AquaSnap measures ATP found in liquid samples, utilizing a honey clipper to consistently collect 100 µl of liquid sample. The device uses a liquid-stable reagent in place of freeze-dried enzymes giving it superior reproducibility and sensitivity. AquaSnap is available in Total and Free format.

**SuperSnap<sup>™</sup> High Sensitivity Surface ATP Test**

SuperSnap is the most sensitive ATP surface test in Hygiena's ATP hygiene monitoring portfolio of all-in-one devices. Designed to work with all Hygiena luminometers, SuperSnap is an all-in-one test which detects extremely low levels of ATP. SuperSnap is predominantly used in food and beverage processing facilities as an allergen cross contamination prevention.

Catalog No.	Description	Quantity
ETOUCH	EnSURE <sup>™</sup> Touch Monitoring System	1
AQ-100X	AquaSnap <sup>™</sup> Total Water ATP Test	100
AQ-100FX	AquaSnap <sup>™</sup> Free Water ATP Test	100
SUS3000	SuperSnap <sup>™</sup> Surface High Sensitivity ATP Test	100

Find support documents, instructional videos, and more at [www.hygiena.com](http://www.hygiena.com)

MPS-024 REV B

Visit Thomsen's Inc. at [www.thomsensinc.com](http://www.thomsensinc.com) or call 866 729 2959





## ***The Thomsen Way!***<sup>™</sup>

- **Patented Dual System for Safe and Easy Cleaning of Escalator Handrails**
- **Three Step Solution Approach, All Solutions Specifically Formulated for Cleaning Escalator Handrails**
  - **Heavy Duty Cleaner**
  - **Cleaner Conditioner**
  - **Sanitizer Solution**
- **ATP Testing Protocol for Documenting Results and Certification**

***Delivery of Cleaner, Healthier, Safer Escalator Rides, Reducing Accidents and Extending the Life of the Escalator Handrail***





# Thomsen's Escalator Handrail Cleaning Equipment and Supply Catalogue

## The Thomsen Way Starter Kit: TH-P-2001

### Maestro Dual Escalator Handrail Cleaning System

- Universal Cart System & Dolly System
- 4 Foam Pad Holders
- 24 Cleaning Pads
- Three 1.5gal Charging Buckets
- One ½ gallon mixing pitcher
- Three 1 oz. gallon pump dispensers
- One Bottle holder

**1 Case of Thomsens Heavy Duty Concentrate 4 x 1 Gallon**

**1 Case of Thomsen's Cleaner Conditioner Concentrate 4 x 1 Gallon**

**1 Gallon of mPerial Sanitizer for Thomsen's Inc.**

**1 Hygiena EnSure™ Touch ATP Metering Tool**

**1 4 x 25 Packets of Test Swabs**

**Software Integration for Documentation**

### Training and Support Includes:

- Safety Binder for Safety Data Sheets
- Video Reference Guide
- Operations Mixing and Frequency Cleaning Protocol Guide
- Software Training Guide
- Key Contact Guide for Ongoing Support and Emergencies
- The Thomsen Way!™ Stickers for Certification

Visit Thomsen's Inc. at [www.thomsensinc.com](http://www.thomsensinc.com) or call 866 729 2959

