

EVOLUTION WAND-TM

CSW-16

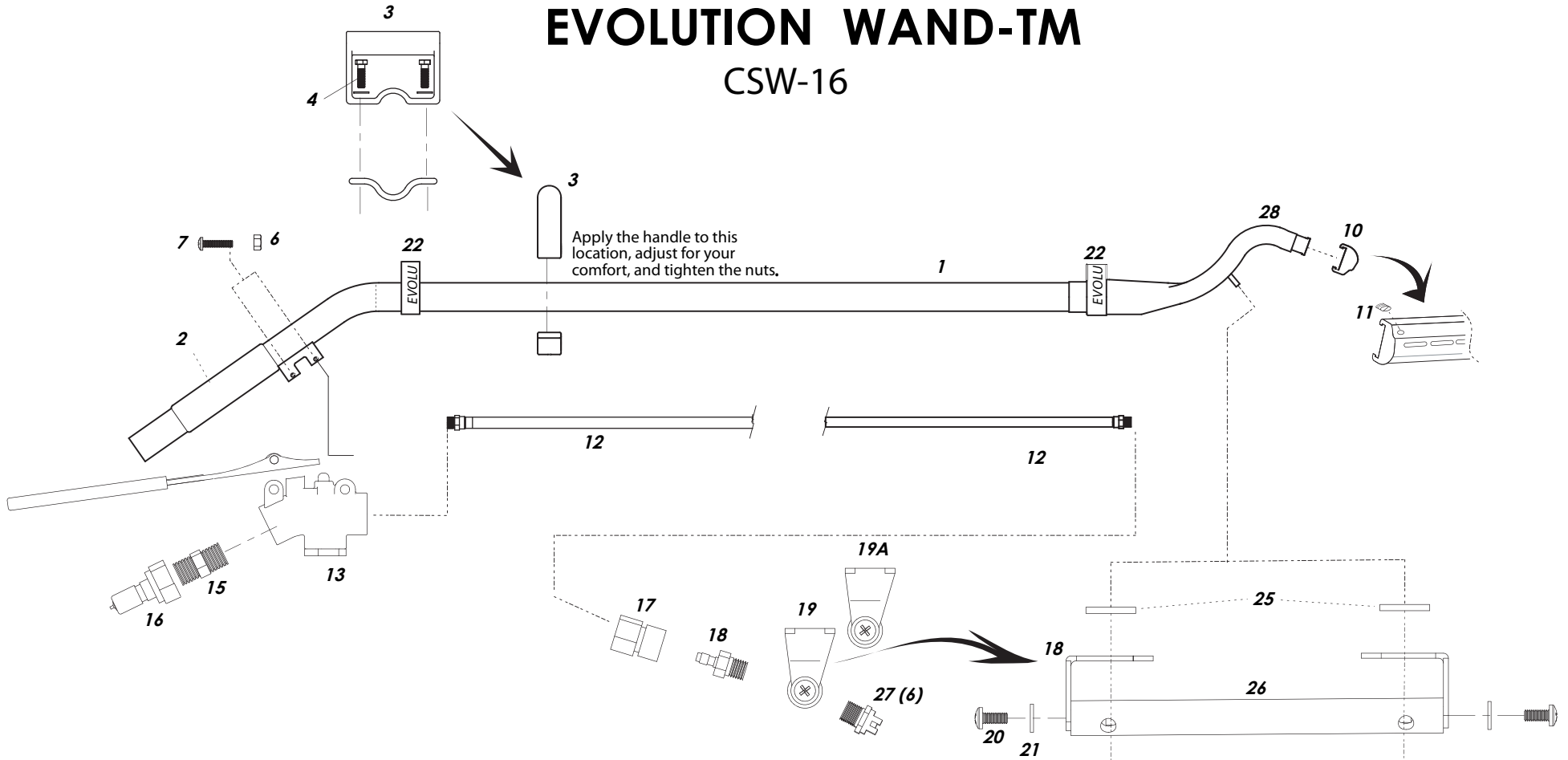

Apply the handle to this location, adjust for your comfort, and tighten the nuts.

Item	Ref. No.	Qty	Description
1	CSW-16	1	Wand, Complete
2	1153B	1	Sleeve, 6"
3	729A	1	Grab Handle, Assy
4	2147	2	Cap screw
6	56002877	2	Nut Hex Nyl Loc SS 8-32
7	1156	2	Screw, 8-32 x 1-1/8"
10	FP639	1	Glide and Set Screw
11	1591	1	Set Screw, S/S 10-24 x 3/8"
12#	56382555	1	Hose, Pressure Line
13#	85KUSP	1	Valve, Complete
[]#	85JUSP	1	Rebuild kit for valve (for use on 85KUSP)
15#	56381218	1	Fitting, Hyd
16#	45USP	1	Quick Disconnect, 1/4 p.t.
17	220	1	Quick Disconnect, 1/4 p.t.

Item	Ref. No.	Qty	Description
18#	221USP	1	Quick Disconnect, 1/4 p.t.
19	2099TMR	1	Bracket, Spray Tube, Right
19A	2099TML	1	Bracket, Spray Tube, Left
20	56002801	2	Scr Hex SS 1/4-20 x .50
21	87036A	2	Washer Flat 10 SS
22	1586	2	Strap, Hook & Loop
23	56002491	2	Nut Hex Nyl Loc SS 1/4-20
24	56009060	2	Wsh Fit SS .26 x 1.00 x .074
25	218	4	Washer, Rubber
26	2098A-S-S	1	Manifold, Spray Bar SS
27	56381595	6	Spray Tip SS 1/8 NPT 110 Deg.
28	3060A	1	Label, Evolution 7.5" x 2.4"

= Revised or new since last update
[] = Not Shown

NOTE: This tool is suitable only for use with water or chemical with a pH between 5 and 10.

Revised 9/11 Form No. 56042550 REV F