

CSW-10

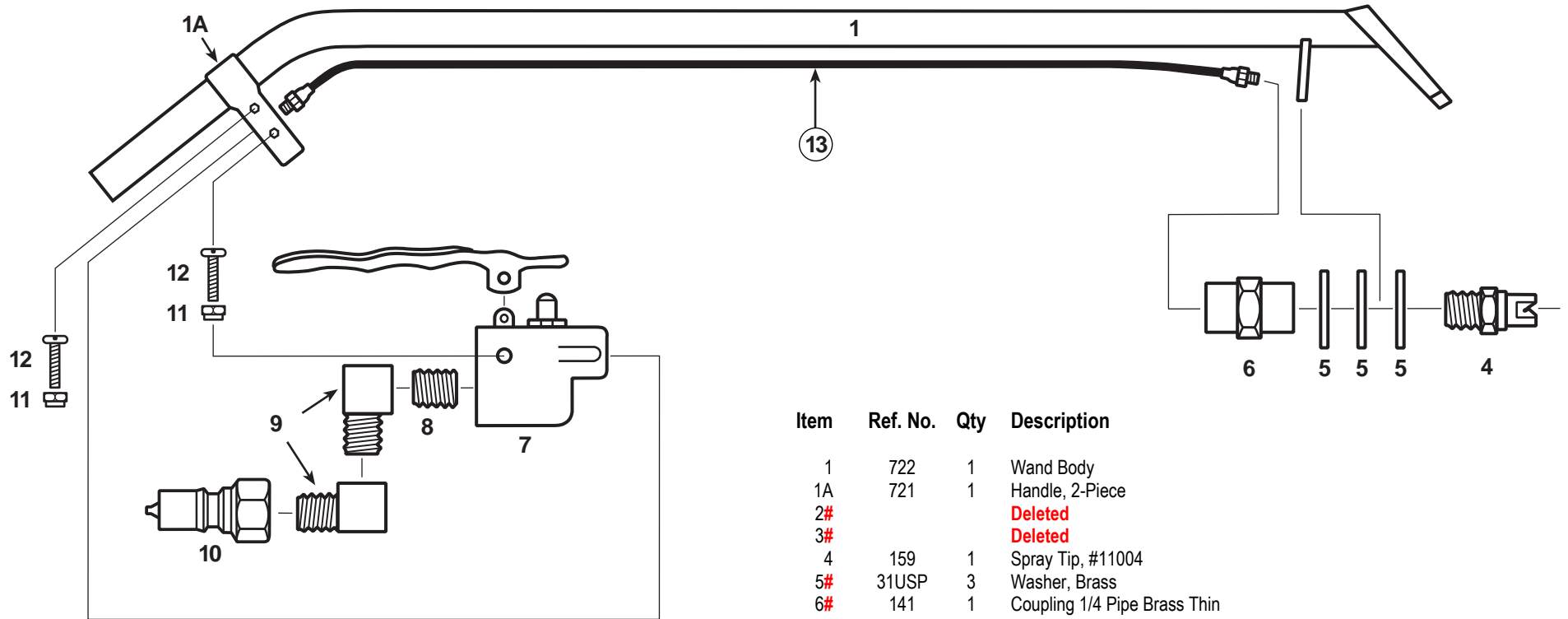

Item	Ref. No.	Qty	Description
1	722	1	Wand Body
1A	721	1	Handle, 2-Piece
2#			Deleted
3#			Deleted
4	159	1	Spray Tip, #11004
5#	31USP	3	Washer, Brass
6#	141	1	Coupling 1/4 Pipe Brass Thin
7	177	1	Valve, PMF, Low Pressure
[]	192	1	Rebuild Kit, Valve (for use on 177)
8#	92USP	1	Brass Nipple
9#	91USP	2	Elbow, Brass, 90 degree, 1/4 pt
10#	45USP	1	Quick-Disconnect, male, 1/4 fpt
11	17	2	Locknut, S/S, 10-32
12#	195	2	Screw 10-32 x 1 Pan Head Ph
13	56381593	1	Pressure Line Replacement
[]#	4339A	1	Label-Caution-Protect Wand from Freezing

= Revised or new since last update

[] = Not Shown

NOTE: This tool is suitable only for use with water or chemical with a pH between 5 and 10.

Revised 9/11 Form No. 56042543 REV G