

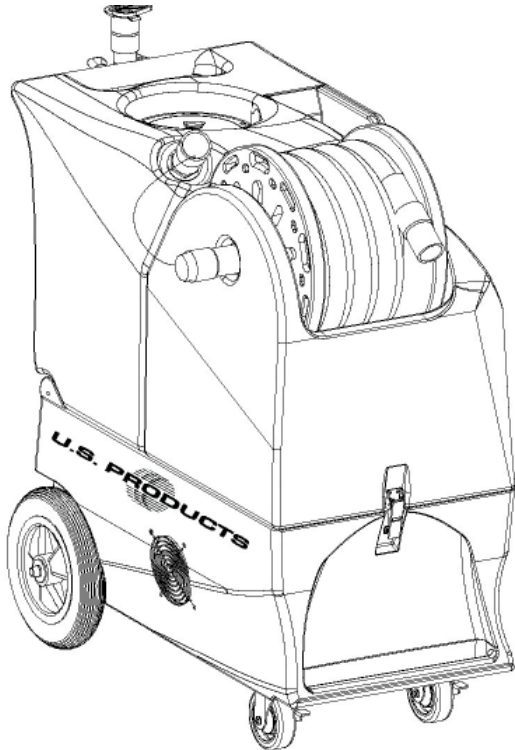

CP-310 EXTRACTOR 120V



INFORMATION & OPERATING INSTRUCTIONS

**DO NOT OPERATE MACHINE UNTIL YOU HAVE READ
ALL SECTIONS OF THE INSTRUCTIONS**

IMPROPER USE OF THE MACHINE WILL VOID THE WARRANTY

1. Always use a defoamer when foaming occurs to prevent vacuum motor damage.
2. Keep machine from rain and snow, extremes in temperatures, and store in a heated location. Use the machine indoors. Do not use outdoors.
3. Do not let the pump run dry.
4. Use approved chemicals only. NO SOLVENTS.
5. Wear gloves or use rags when removing quick disconnects to prevent burns.

IMPORTANT SAFETY INSTRUCTIONS

This machine is only suitable for commercial use, for example in hotels, schools, hospitals, factories, shops and offices other than normal residential housekeeping purposes.

When using any electrical appliance, basic precautions should always be followed, including the following:

NOTE: Read all instructions before using this machine.

WARNING!

To reduce the risk of fire, electric shock, or injury:

- Do not leave the machine unattended when it is plugged in. Unplug the unit from the outlet when not in use and before servicing.
- To avoid electric shock, do not expose to rain or snow. Store, and use, indoors.
- Do not allow to be used as a toy. Close attention is necessary when used near children.
- Use only as described in this manual. Use only the manufacturer's recommended attachments.
- Never add water over 130° F/54° C to the solution tank.
- Do not use with damaged cord or plug. If the machine is not working as it should, has been dropped, damaged, left outdoors or dropped into water, return it to a service center.
- Do not pull by the cord, use the cord as a handle, close a door on the cord, or pull the cord around sharp edges or corners. Do not run the machine over the cord. Keep the cord away from heated surfaces. To unplug, grasp the plug, not the cord.
- Do not handle the plug, the cord or the machine with wet hands.
- Extension cords must be 12/3 and no longer than 50 feet. Replace the cord or unplug immediately if the ground prong becomes damaged.
- Do not put any object into openings. Do not use with any opening blocked; keep free of dust, lint, hair, and anything that may reduce air flow.
- Keep loose clothing, hair, fingers, and all parts of body away from openings and moving parts.
- Do not pick up anything that is burning or smoking, such as cigarettes, matches, or hot ashes, or any health endangering dusts. Do not use to pick up flammable or combustible liquids such as gasoline or use in areas where they may be present.
- Turn off all controls before unplugging.
- Use extra care when cleaning on stairs.
- Connect to a properly grounded outlet only.
- Liquid ejected at the spray nozzle could be dangerous as a result of its temperature, pressure, or chemical content.

INSPECTION:

Carefully unpack and inspect your COBRA PLUS-310 for shipping damage. Each machine is tested and inspected before shipping. Any shipping damage incurred is the responsibility of the carrier. You should notify the carrier immediately if you notice damage to the box or to the machine or parts.

CLEANING SOLUTIONS:

We recommend liquid cleaning chemicals, such as our Magic Fabric Cleaner. Powder chemicals may be used, but unless mixed very thoroughly they could cause a build-up in the pump, lines, heat exchanger and/or quick disconnects. Any problem caused by a chemical build-up is not covered by warranty. Use a neutral cleaner with a pH between 6 and 9 to avoid premature wear of the pump, seals, and/or other components. Damage caused by the use of strong chemicals is not covered by the warranty.

MAINTENANCE:

For optimum performance flush the machine with clear water at the end of each working day. Once a month, minimum, run a flushing compound through the machine to break up any mineral or chemical build-up that may have formed. U.S. Products "X-1500" is recommended. Lubricate the wheels, castors, and quick disconnects with an all purpose silicone spray. The vacuum and the pump do not require any maintenance. Clean the body with an all purpose detergent, and protect it with an automobile interior polish.

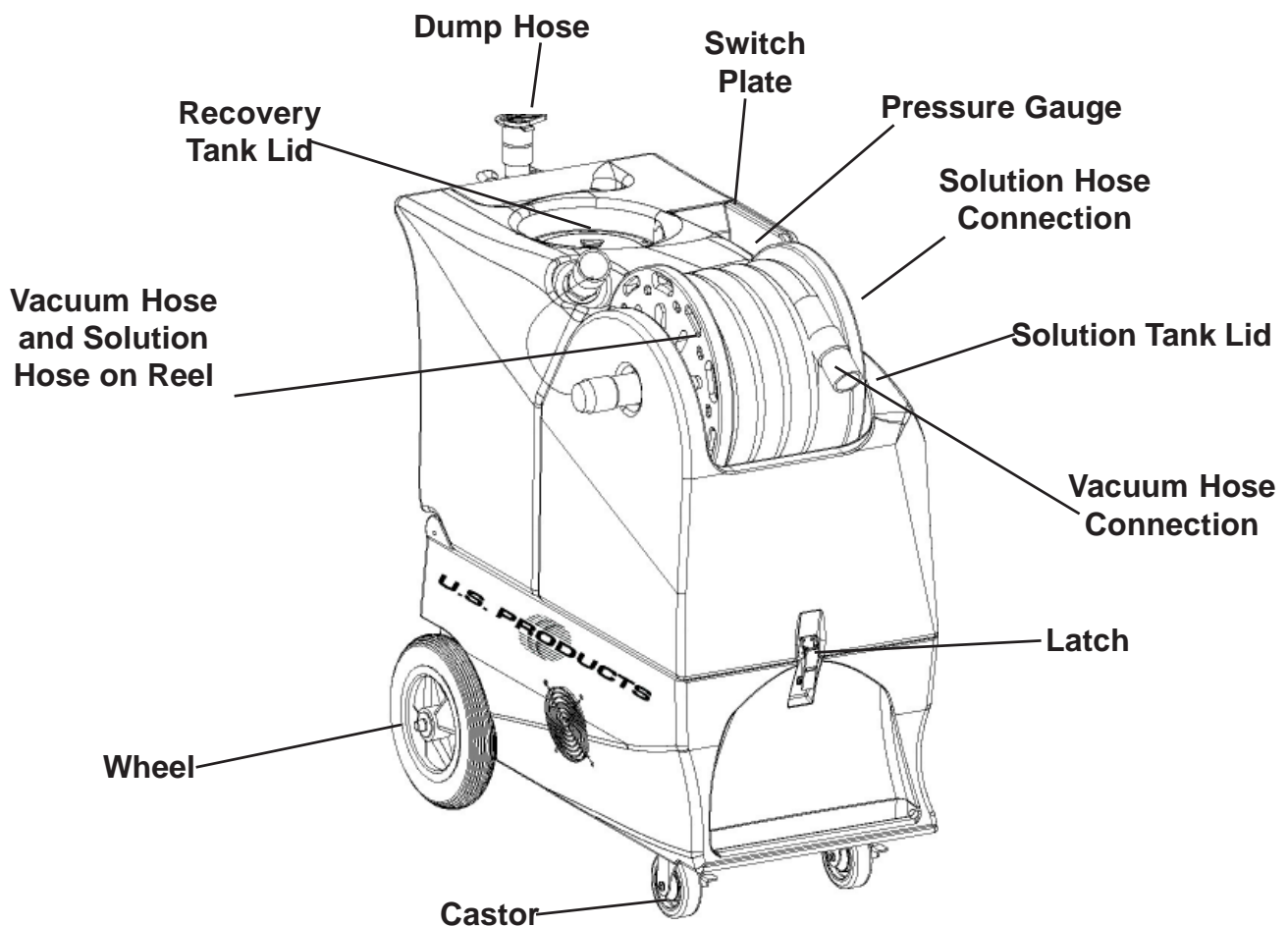

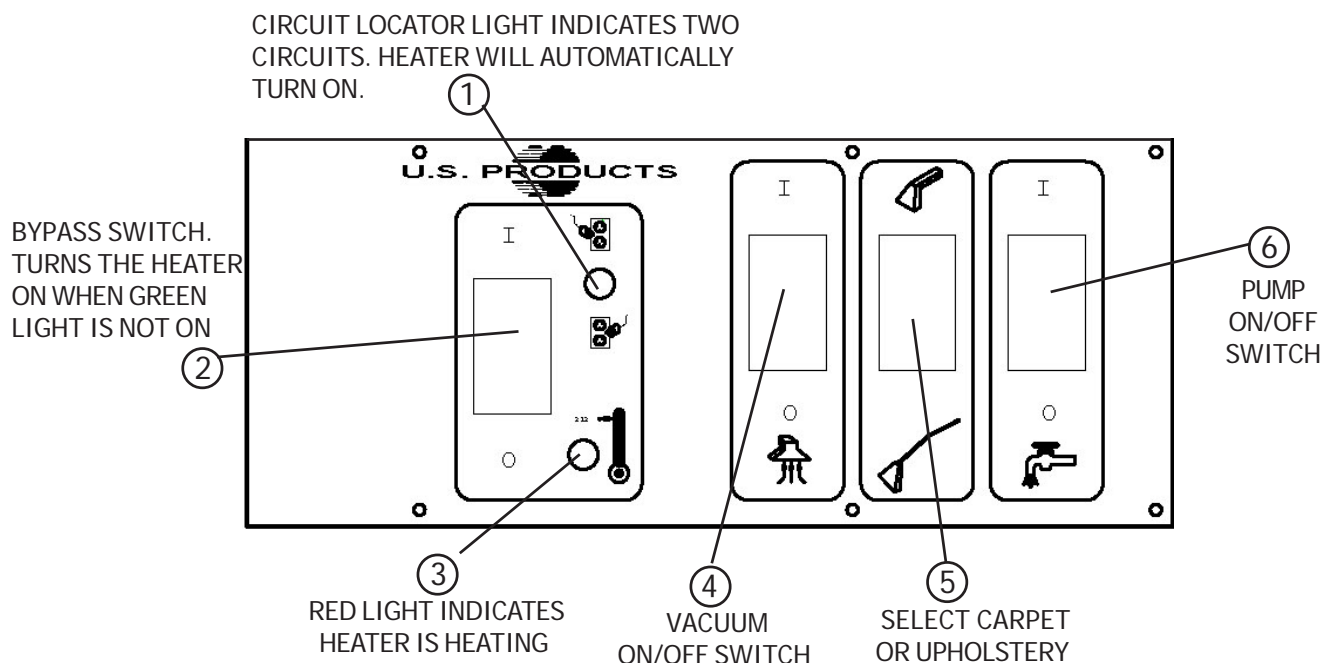

Record the serial number and model of your new extractor here:
(and be sure to mail your warranty card)

Serial Number: _____

Model: COBRA PLUS-310

Purchase Date: _____

Write the name and phone number of your
distributor:

OPERATION

- 1 Inspect the machine, hoses, and cleaning tools for cleanliness and completeness.
- 2 Fill the solution tank with water. Using warm water may be a benefit in cleaning effectiveness, but do not use hot water (above 130° F / 54°C) in the tank.
- 3 Plug in the power cords. Do not connect both cords to the same outlet; the green circuit locator light (1) on the switch plate should light up. If the locator light does not come on, try different outlets until it does. If you are certain the cords are on separate circuits, turn the bypass switch ON (2). This will allow the heater to turn on.

CAUTION: using the bypass switch when the cords are on the same circuit may cause the breaker in the wall to trip. **NOTE:** the red light will turn on only when the heat exchanger is actively heating.

- 4 Connect the priming hose to the machine, turn the pump switch ON (6) and prime the air out of the pump by allowing the water to flow unrestricted. When the water is clear (no air in it) turn the pump off and remove the priming hose. **NOTE:** if priming is difficult, place the open end of the priming hose into the vacuum inlet hose barb, and turn the vacuum on (4). Use your hand to

block the open area in the hose barb. This will allow the pump and the vacuum to work together to get the water moving. Priming may take 20-60 seconds, and the solution tank should be full.

Once the pump is primed, turn the pump and the vacuum OFF. Remove the priming hose.

- 5 Add liquid cleaning chemical, with a pH between 6 and 9, to the solution tank.
- 6 Attach the spray hose to the solution quick disconnect and the vacuum hose to the hose barb on the recovery tank. Pull the hoses out of the reel. Attach the other ends of the hoses to the cleaning tool.
- 7 Allow the heat exchanger two minutes to reach operating temperature. The red light (3) will go out when the heater has reached maximum operating temperature.
- 8 Turn the pump on and set the pressure selection switch to the desired spraying pressure: 300 or 50 PSI).
- 9 Turn the vacuum ON.
- 10 Begin cleaning using the correct hoses and tool.
- 11 Use defoamer in the recovery tank any time foaming occurs.
- 12 Monitor the water level in the solution tank. Do not let the pump run dry.
- 13 When the solution tank gets low, turn the pump and the vacuum off, fill the solution tank, empty and clean the recovery tank.
- 14 When finished with the job, remove any unused solution from the solution tank, and run a few gallons of clean water through the system. Drain the recovery tank by placing the dump hose over a drain, or into a bucket, and remove the hose cap. Disconnect the hoses from the cleaning tool, and reel the hoses up onto the hose spool.

NOTE: to remove the reel, with the hoses, from the machine, pull the vacuum hose loose from the hose barb on the front of the tank. Disconnect the solution hose quick coupling. Push the vacuum hose into the center of the spool. Grasp the spool on both sides, and lift it off the machine. **NOTE:** before servicing any component in the base cabinet, the hoses and spool must be removed from the machine before the tanks can be lifted open.

ELECTRIC CIRCUIT LOCATOR

This unique, patented system is operated by a solid state circuit. It will inform the operator when the two cords are plugged into separate circuits by turning on the circuit locator light. This helps to prevent tripping circuit breakers. **NOTE:** if the green, circuit locator light does not illuminate when the cords are plugged in, then both cords are on the same circuit. Try other outlets with one of the cords until you get the locator light to come on. **NOTE:** if the bypass switch is turned on when both cords are on the same circuit, the breaker in the wall may trip.

BALL FLOAT VACUUM SHUT-OFF:

Prior to using the machine, always check that the float filter is clean and the ball can travel freely. When the recovery tank is full, the ball float will rise and will shut off the vacuum flow to prevent any more water from entering the tank. Turn off the vacuums, and empty the recovery tank.

NOTE: if foam is present, or if the ball float is prevented from rising, the float will not be able to stop the air flow, and the tank may over fill. Water damage to the vacuum motors is not covered by warranty.



CAUTION: to avoid vacuum motor damage, always use a defoamer any time foam is present.

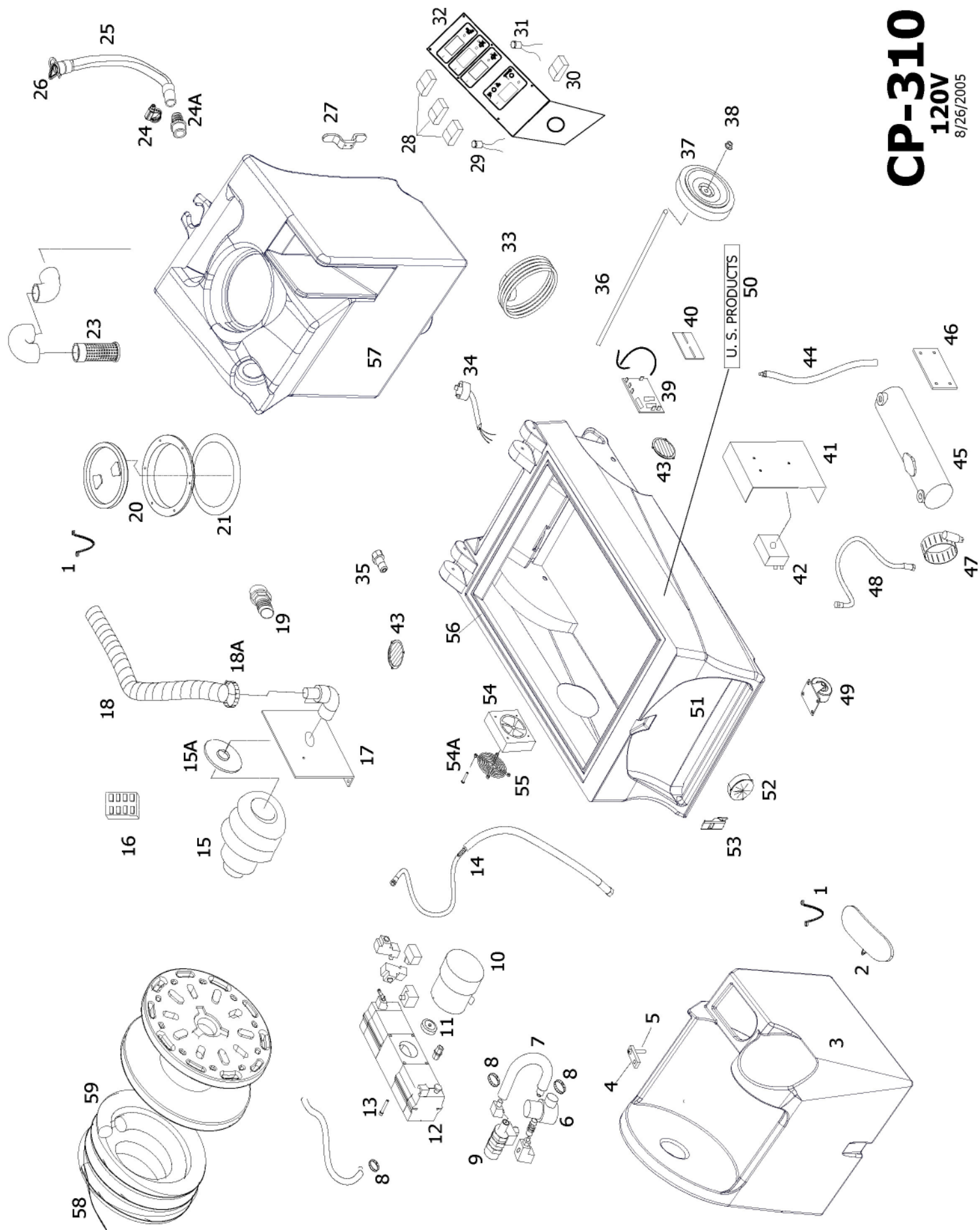

CP-310

120V
8/26/2005

COBRA PLUS-310 EXTRACTOR

PART LIST

120V

| <u>ITEM</u> | <u>PART No.</u> | <u>DESCRIPTION</u> | <u>ITEM</u> | <u>PART No.</u> | <u>DESCRIPTION</u> |
|-------------|-----------------|-----------------------------------|-------------|-----------------|---|
| 1 | 805 | Chain, lid, 8" | 41 | 2025 | Heat sink plate |
| 2 | FP446 | Lid, solution tank | 42 | ----- | See miscellaneous |
| 3 | HKCR1 | Holding tank, white | 43 | 928 | Louver, 3", includes screws |
| 4 | 1088 | Glide, teflon | 44 | 1377 | Hose, hydraulic, 27-3/4" |
| 5 | 178 | Screw, 6-32 X 1/2" | 45 | FP357 | Heat exchanger, complete |
| 6 | 2062 | Solenoid valve | 46 | 455 | Mount, heat exchanger |
| 7 | 925 | Hose, 3/8" X 8" | 47 | 76 | Hose clamp |
| 8 | 156 | Hose clamp | 48 | 1278 | Hose, hydraulic, 13" |
| 9 | 945 | Valve, bypass | 49 | 905 | Castor, 4" |
| 10 | 2060 | Motor, pump | 50 | 1128006 | Label, CP-310 |
| 11 | 950A | Cam/bearing assembly | 51 | BKCR-BLK | Base, black |
| 12 | FP449 | Pump complete, no mtr or soleniod | 52 | 951A | Pressure gauge |
| 13 | 1147 | Cap screw, pump to motor | 53 | 908A | Latch, rubber |
| 14 | FP356 | Hose assembly, pump to gauge | 54 | 2014 | Fan, 100 CFM, cooling |
| 15 | 913 | Vacuum motor, 3-stage | 54A | 2B1 | Screw, 6-32 X 2-1/4" |
| 15A | 959 | Gasket, vacuum motor | 55 | 2015 | Guard, cooling fan |
| 16 | 4405A | Relay, vacuum | 56 | FP228A | Gasket, 87" |
| 17 | 926 | Manifold, vacuum motor mount | 57 | VKCR-1 | Vacuum tank, white |
| 18 | 1136 | Hose, vacuum inlet, 1-1/2" X 24 " | 58 | FP443 | Pressure line, complete |
| 18A | 156 | Hose clamp | 59 | 919G | Vacuum hose, complete |
| 19 | 907 | Hose barb, for vacuum hose | | | |
| 20 | 2086 | Lid, vacuum, with ring | | | |
| 21 | 1074 | Gasket, lid | | | |
| 23 | FP364 | Ball float assembly | | | |
| 24 | 156 | Hose clamp | | | |
| 24A | 907 | Hose barb/vacuum hose | | | |
| 25 | 1060B | Hose, drain, 1-1/2" x 24" | | | |
| 26 | 1060C | Plug, drain hose | | | |
| 27 | CWKC-BLK | Cord wrap, Black | | | |
| 28 | FP345 | Switch and acuator, motors | | | |
| 29 | 78 | Light, green, 120V | | | |
| 30 | FP346 | Switch and actuator, heat/bypass | FP194C | | Heat Repair kit includes probe,thermistor control, thermal cutout & circuit board |
| 31 | 78B | Light, red | FP194A | | Heat Repair kit includes probe,thermistor control & circuit board |
| 32 | 1357 | Switch plate | FP449 | | Pump & motor complete |
| 33 | 1057B | Cord, power, 25 ft, yellow | FP444 | | Vacuum hose & pressure line, with reel complete |
| 34 | 1062 | Receptacle, power cord | FP445 | | Vacuum hose & pressure line, complete, no reel |
| 35 | 45 | Quick disconnect, male, 1/4 p.t. | | | |
| 36 | 910 | Axle, cut to length, 18-1/4" | | | |
| 37 | 2084 | Wheel, 10" | | | |
| 38 | 27A | Axle cap | | | |
| 39 | 923B | Dual circuit sensor PCB | | | |
| 40 | FP336 | PCB mount, snap track | | | |

MISCELLANEOUS PARTS AND KITS

| | |
|--------|---|
| FP194C | Heat Repair kit includes probe,thermistor control, thermal cutout & circuit board |
| FP194A | Heat Repair kit includes probe,thermistor control & circuit board |
| FP449 | Pump & motor complete |
| FP444 | Vacuum hose & pressure line, with reel complete |
| FP445 | Vacuum hose & pressure line, complete, no reel |

CP-310 EXTRACTOR 120V

SPECIFICATIONS:

Rotomolded Body: Lifetime Warranty
Vacuum: 7.2" 3-stage
VAC Shutoff: Ball float
Pump: Positive displacement, selectable pressure setting
Waterlift: 140"
Heat: Instant to 212° F
Heater: 2000 Watts
Wand: Stainless steel, double bend, twin tip
Weight: 112 lbs.
Dimensions: 38" H x 17 3/4" W x 36" L



208-772-0573 • 800-257-7982 • FAX: 208-772-0577

Coeur d'Alene, Idaho

VISIT US AT: <http://www.usproducts.com>